

DENNIS PIERCE, INC.

HOME BUILDER



Building quality homes since 1980

www.DennisPierce.com

(601) 264-6800

LOT	PRICE	ACREAGE
LOT 1	22,900	0.94
LOT 6	22,900	0.99
LOT 7	22,900	0.86
LOT 11	24,900	0.66
LOT 28	28,900	0.59
LOT 29	23,900	0.55
LOT 30	23,900	0.59
LOT 31	22,900	0.59
LOT 32	22,900	0.58
LOT 33	24,900	0.50
LOT 43	29,000	1.38
LOT 66	22,900	0.57
LOT 77	22,900	0.58
LOT 85	22,900	0.87
LOT 100	25,900	0.91
LOT 101	24,900	0.85
LOT 116	24,900	0.64
LOT 118	21,900	0.74
LOT 127	26,900	0.51
LOT 130	26,900	0.62
LOT 131	21,900	0.61
LOT 142	30,900	0.54
LOT 147	34,900	0.41
LOT 148	17,900	0.58
LOT 155	24,900	0.42
LOT 156	19,900	0.80
LOT 157	26,900	0.76
LOT 177	14,900	0.45
LOT 178	19,900	0.40
LOT 179	24,900	0.53
LOT 197	22,900	0.65
LOT 210	23,900	1.11



Sold

Dennis Pierce Inc. Office

- Go south on Old Hwy 11 towards Purvis 1.7 Miles
- Turn Right onto Old Hwy 24 3 Miles
- Bent Creek West entrance is on the right

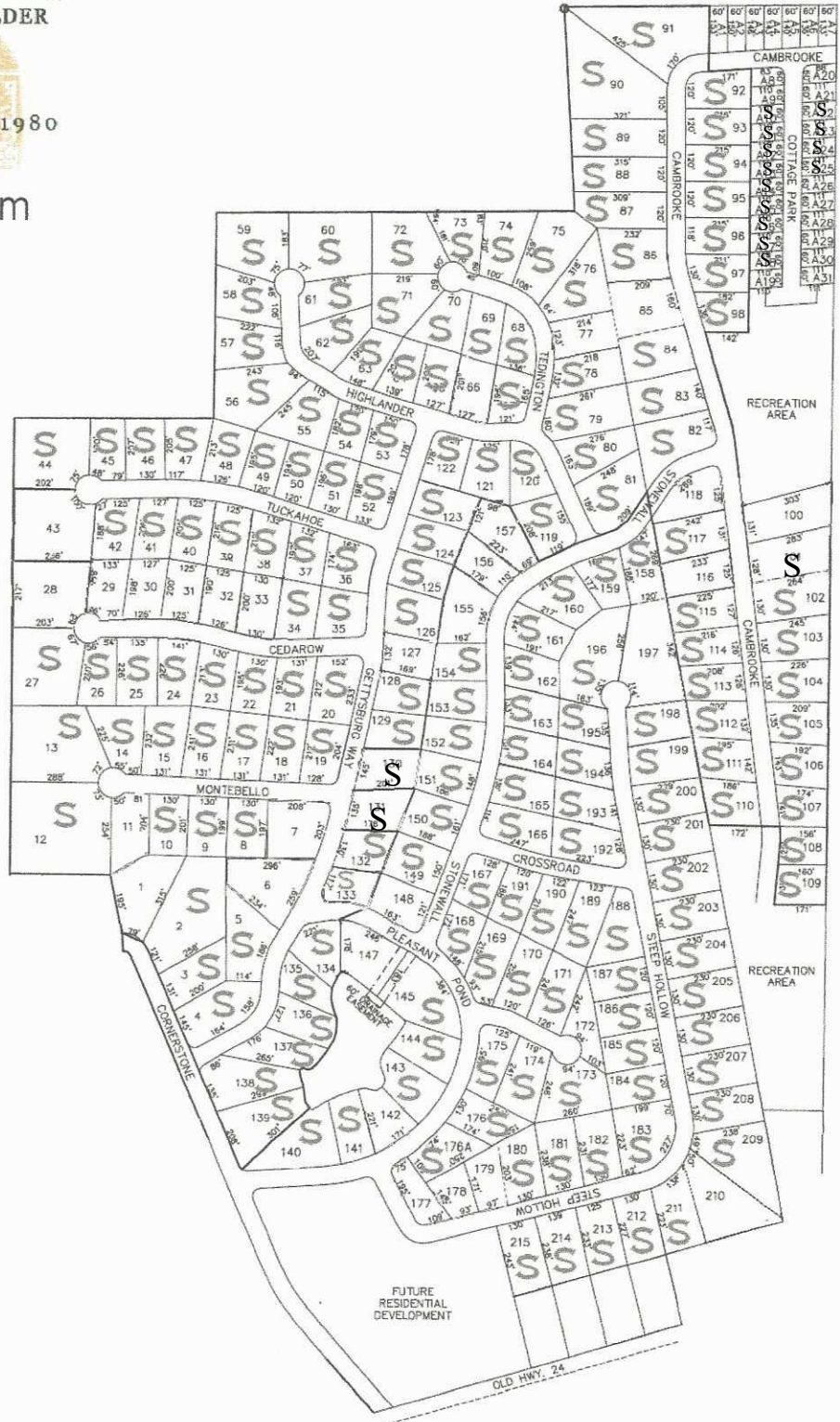

Bent Creek West

From Piercon Office

- Go south on Old Hwy 11 towards Purvis 1.7 Miles
- Turn Right onto Old Hwy 24 3 Miles
- Bent Creek West entrance is on the right

DENNIS PIERCE, INC.

HOME BUILDER



Building quality homes since 1980

www.DennisPierce.com

(601) 264-6800



LOT	PRICE	ACREAGE
Lot 216	37,900	0.77
Lot 217	34,900	0.73
Lot 221	37,900	0.74
Lot 222	36,900	0.66
Lot 223	37,900	0.65
Lot 224	38,900	0.65
Lot 225	27,900	0.69
Lot 231	26,900	0.74
Lot 232	27,900	0.74
Lot 233	26,900	0.74



Sold

Bent Creek West (Third Filing)